



Gulliver's Year 2 Residential

A two day adventure!!

Pathway Curriculum

- The residential sits as part of our wider curriculum offering of the Pathway Curriculum.
- Being away from home for a night is a FOOTPRINT on our Pathway Pad





Things to know before we go

- Leaving on Thursday 4th June at 9.15am and back around 3.30/4pm on Friday 5th June. Coach will leave from back gate.
- Mrs Isaac, Mrs Mills, Mrs Fitts, Mr Craven and Miss Sandon will be attending.
- All payments must be made up to date before departure, please go to the Office if there are any concerns.
- Food choices should all be chosen prior to trip.
- Please ensure that all forms are completed before departure
- Please meet with Mrs Wilson if you have any concerns about individual needs
- Kit List is available for you to take away today
- No electronic devices or sweets



KIT LIST (1)

Large rucksack (or alternative bag/suitcase)

Small rucksack (for daytime)

Trousers/joggers/leggings

T-Shirts (shoulders covered)

Warm jumper / fleece

Waterproof jacket

Socks and underwear

Pyjamas

Comfortable footwear such as trainers

Small towel

Wash Bag (toothbrush, toothpaste, hair brush, hairbands & face wipes)

Water bottle

Sun cream and sun hat



KIT LIST (2)

Please do not go out and buy all new and expensive kit to come on our trips.

If you have appropriate footwear and some warm clothes you will be fine!

We ask you do not bring sweets or snacks, particularly those containing nuts.

We also do not advise bringing electronic equipment, such as mobile phones.

Please pack the bag alongside your child



Things to know whilst we are there

- All updates will be placed on Facebook including photos
- All children have been allocated a lodge with someone that they had on their list
- Each brand lodge contains 4 children's bedrooms, two toilets and lounge.
- Areas around the lodges are completely enclosed and secure.
- We will contact you if we need to.





Explorer lodge sleeps up to 8 children
2 toilets (separate toilet for adults)

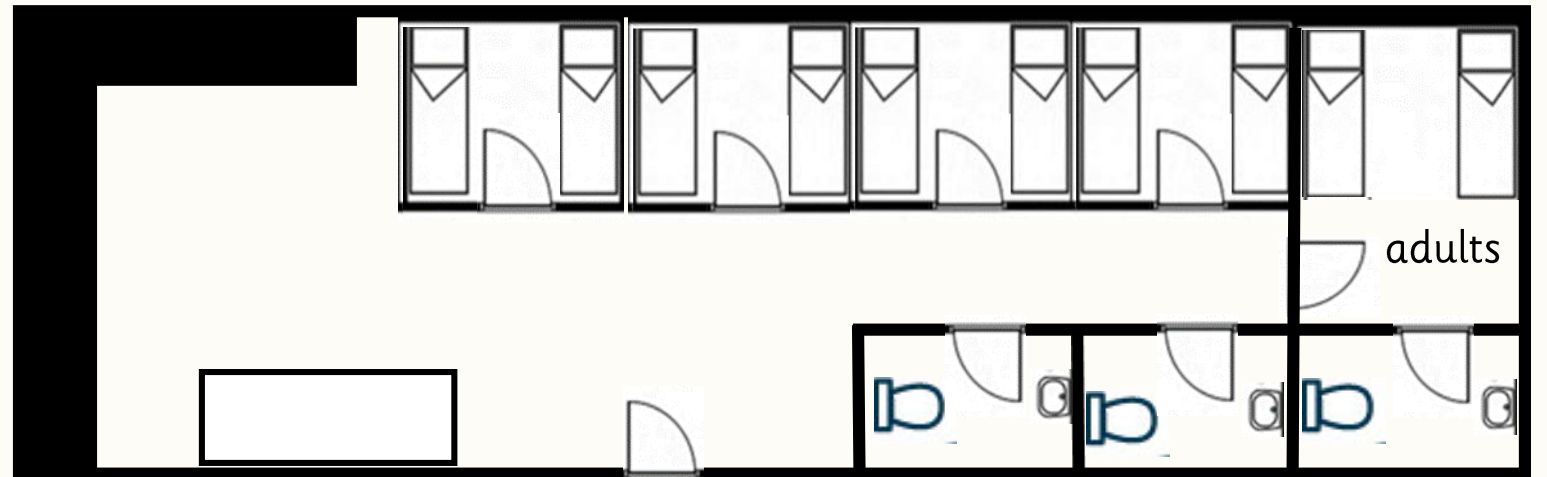



Activities

Five activities during the two days:

- Theme park
- Animal Encounters – Learning about different types of animals and meeting some of the animal residents at Gulliver's.
- Team challenge – Communicating and working as a team to complete problem solving activities.
- Evening activity - Film



Any questions?

If your child needs any adjustments please make a meeting with Mrs Wilson.